

PRODUCT SPECIFICATION

D2241/RJIB CERTA-LOK® YELOMINE® PVC PRESSURE PIPE | Restrained Joint Integral Bell

Our D2241/RJIB Certa-Lok® Yelomine® PVC Pressure Pipe is manufactured to meet the demands of today’s municipal needs for water and wastewater applications. Certa-lok pipe utilizes precision-machined grooves on the pipe and in the integral bell which, when aligned, allow a spline to be inserted, resulting a fully circumferential restrained joint. A flexible elastomeric gasket in the integral bell provides a hydraulic seal.

Trenchless & Restrained Joint Open-Cut Applications: This unique restrained joint pipe system is designed for trenchless applications with robust tensile strength for pulling multiple segments underground. The smooth curve at the bell specifically reduces friction and allows for quick and easy assembly without interrupting the pulling process. This product reduces the jobsite footprint and minimizes community disruption with a reduced need for larger staging area and traffic control.

Yelomine Formulation Enhancement for Aboveground and Temporary Bypass Applications: Yelomine products are manufactured from a specially formulated PVC compound that contains impact modifiers and UV inhibitors. This special formulation provides up to 6x the impact strength of normal PVC pipe over an extended period of time allowing for Yelomine products to be used above ground and in high-impact situations like temporary bypass. Joints assembled with the non-permanent gasket option can be disassembled and reused for future jobs or system changes.

INSTALLATION METHODS

- Above Ground
- Temporary Bypass
- Static Pipe-bursting
- Horizontal Directional Drilling
- Open-cut

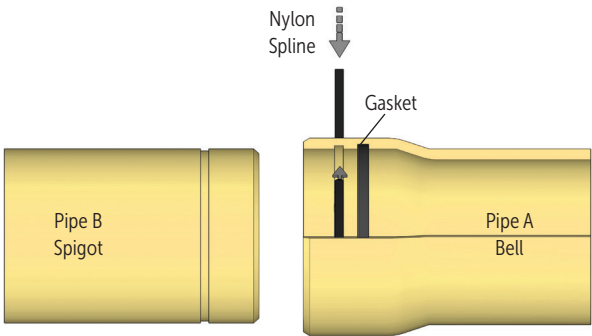

| Applications | Potable Water | Wastewater | Reclaimed Water |
|-----------------|---------------|------------|-----------------|
| Pipe Color: | Yellow | Green | Purple |
| Certifications: | NSF 61 | None | None |



PRODUCT SPECIFICATION

D2241/RJIB CERTA-LOK® YELOMINE® PVC PRESSURE PIPE

Restrained Joint Integral Bell

SHORT FORM SPECIFICATION

| | |
|--------------------------------------|--|
| Pipe Standard: | ASTM D2241 |
| Diameter Std.: | Iron Pipe Size (IPS) |
| Nominal Sizes: | 4", 6", 8" |
| Dimension Ratios & Pressure Ratings: | SDR 21 – 200 psi SDR 17 – 250 psi |
| Lay Length: | 20' |
| Pipe Compound: | ASTM D1784 Cell Class 12454 with Yelomine Technology |
| Pipe Joint Std.: | ASTM D3139 |
| Max. Angular Joint Deflection:‡ | 0.5° |
| Gasket Standard: | ASTM F477 |
| Gasket Material Offering: | NBR |
| Installation Std.: | ASTM D2774 |

‡See Installation Guide for more information.

D2241/RJIB CERTA-LOK® YELOMINE® PIPE DIMENSIONS

| Nom. Size | Outside Diameter (OD) | SDR | Pipe | | | | | | | | |
|-----------|-----------------------|-----|--------------------------|----------------------------|-----------------------------|-------|-------|-------|-------|-------|----------------|
| | | | Min. Wall Thickness (T1) | Spigot Wall Thickness (T2) | Flow Internal Diameter (ID) | X | W | D | P | BOD | Weight (lb/ft) |
| 4" | 4.500 | 21 | 0.214 | 0.335 | 4.072 | 3.000 | 0.375 | 0.135 | 0.210 | 5.112 | 1.9 |
| | | 17 | 0.265 | 0.400 | 3.970 | | | | | 5.264 | 2.3 |
| 6" | 6.625 | 21 | 0.316 | 0.485 | 5.993 | 3.000 | 0.375 | 0.135 | 0.210 | 7.500 | 4.1 |
| | | 17 | 0.390 | 0.590 | 5.845 | | | | | 7.737 | 5.0 |
| 8" | 8.625 | 21 | 0.410 | 0.625 | 7.805 | 3.163 | 0.500 | 0.145 | 0.603 | 9.750 | 7.0 |

Notes:

- These dimensions are for estimating purposes only. All dimensions are in inches unless otherwise specified.
- SDR = Standard Dimension Ratio
- ASTM Pressure Class @ 73°F and includes 2:1 safety factor.
- Maximum Pull Force based on actual testing and includes 2:1 safety factor.
- Internal diameter calculated using nominal outside diameter and minimum wall thickness.
- Additional wall thickness provides additional joint strength in machined areas. This has been calculated to have a negligible effect on flow performance.
- Contact Technical Services for assistance with mandrel sizing.

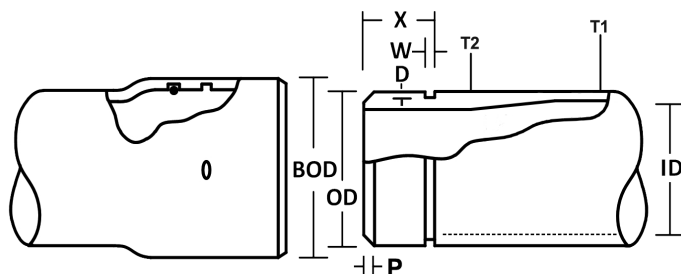

PRODUCT SPECIFICATION

D2241/RJIB CERTA-LOK® YELOMINE® PVC PRESSURE PIPE

Restrained Joint Integral Bell

JOINT PERFORMANCE DATA

| Nom. Size | DR | Pressure Class (psi) | Min. Bend Radius (ft) | Max. Pull Force (lbf) |
|-----------|----|----------------------|-----------------------|-----------------------|
| 4" | 21 | 200 | 75.0 | 6,500 |
| | 17 | 250 | | 6,800 |
| 6" | 21 | 200 | 100 | 8,200 |
| | 17 | 250 | | 11,300 |
| 8" | 21 | 200 | 144 | 15,500 |

D2241/RJIB CERTA-LOK® YELOMINE® CERTA-LOK® ACCESSORIES

| Application | Nom. Size | Splines | | | | Gaskets | | | |
|-------------------------|-----------|----------|-------------|--------|-------------|----------|-------|-------|-------------|
| | | Material | Size | Length | Part Number | Material | Shape | Size | Part Number |
| Permanent Standard* | 4" | Nylon | 0.250 Dia | 18 | S4518RN0 | NBR | Round | 0.240 | OR040YMPI |
| | 6" | Nylon | 0.250 Dia | 24 | S0624RN0 | NBR | Round | 0.313 | OR060YMPI |
| | 8" | Nylon | 0.313x0.313 | 32 | S0832SN1 | NBR | Round | 0.400 | OR080YMPI |
| Non-Permanent Standard* | 4" | Nylon | 0.250 Dia | 18 | S4518RN0 | NBR | Round | 0.210 | OR040YMNN |
| | 6" | Nylon | 0.250 Dia | 24 | S0624RN0 | NBR | Round | 0.275 | OR060YMNN |
| | 8" | Nylon | 0.313x0.313 | 32 | S0832SN1 | NBR | Round | 0.375 | OR080YMNI |

* Non-permanent gaskets are typically used in temporary bypass applications that require disassembly and reuse of the joint. They should never be specified for permanent, buried, or submerged applications.

Permanent gaskets are slightly larger and make disassembly of the joint more difficult. They are intended for all installations that do not require disassembly during the system's service life including buried installation, river and road crossings, and all installations that would expose joints to long-term or excessive misalignment due to external loads.

If in doubt as to which gasket should be chosen, consult your Sales Representative or Technical Services Group.