



C900/RJIB Certa-Lok® with Fluid-Tite® Gasket PVC Pressure Pipe Restrained Joint Integral Bell

NAPCO's C900/RJIB Certa-Lok PVC Pressure Pipe is manufactured to meet the demands of today's municipal needs for water and wastewater pressure applications. This unique integral bell restrained joint pipe system is designed for trenchless applications with robust tensile strength for pulling multiple segments underground. The smooth curve at the bell specifically reduces friction and allows for quick and easy assembly without interrupting the pulling process.

A segmented PVC pipe solution, this product reduces the jobsite footprint and minimizes community disruption with a reduced need for jobsite staging area and traffic control. The Fluid-Tite gasket offered in sizes 6" through 12" has a superior sealing surface for a leak-free joint and greater deflection capability.

INSTALLATION METHODS

- Horizontal directional drilling (HDD)
- Static pipe-bursting
- Open-cut
- Carrier pipe inside casings

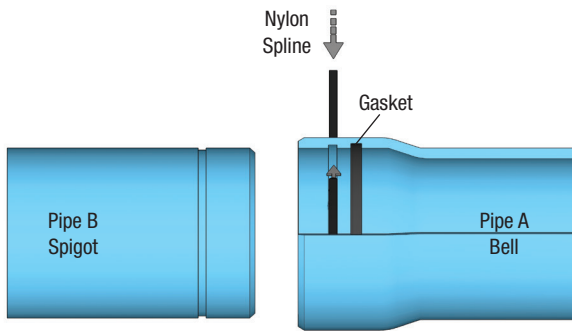

Applications	Potable Water	Wastewater	Reclaimed Water
Pipe Color:	Blue	Green	Purple
Certifications:*	NSF 14 NSF 61 FM 1612† UL 1285	None	None

Short Form Specification	
Pipe Standard:	C900
Diameter Std.:	Cast Iron Outside Diameter (CIOD)
Nominal Sizes:	6", 8", 10", 12"
Dimension Ratios & Pressure Ratings:	DR 18 – 235 psi (185 psi)† DR 14 – 305 psi (250 psi)†
Standard Lay Length:**	10', 20'
Pipe Compound:	ASTM D1784 Cell Class 12454
Pipe Joint Std.:	ASTM D3139
Max. Angular Joint Deflection:‡	0.5°
Gasket Standard:	ASTM F477, UL 157
Gasket Material Offering:	IR/SBR
Installation Std.:	AWWA C605

* 10' Lengths are not hydrotested.

**See Certification Letter for full explanation and list of exceptions.

†FM 1612 calculates pressure ratings differently than AWWA with DR 18 as 185 psi and DR 14 as 250 psi.

‡See Installation Guide for more information.





C900/RJIB Certa-Lok® with Fluid-Tite® Gasket PVC Pressure Pipe Restrained Joint Integral Bell

C900/RJ CERTA-LOK PIPE & COUPLING DIMENSIONS										
Nom. Size	Outside Diameter (OD)	DR	Pipe							
			Min. Wall Thickness (T)	Internal Diameter (ID)	X	W	D	P	BOD	Weight (lb/ft)
4"	4.800	18	0.267	4.266	3.000	0.375	0.135	0.302	5.964	4.0
		14	0.343	4.114						
6"	6.900	18	0.383	6.134	3.000	0.500	0.145	0.271	7.816	5.3
		14	0.493	5.914					8.030	6.6
8"	9.050	18	0.503	8.044	3.163	0.500	0.145	0.634	10.262	9.1
		14	0.646	7.758					10.542	11.5
10"	11.100	18	0.617	9.866	3.625	0.750	0.215	0.634	12.781	13.7
		14	0.793	9.514					13.177	17.3
12"	13.200	18	0.733	11.734	3.625	0.750	0.215	0.634	15.247	19.4
		14	0.943	11.314					15.681	24.5

Notes:

1. These dimensions are for estimating purposes only. All dimensions are in inches unless otherwise specified.
2. DR = Dimension Ratio
3. AWWA Pressure Class @ 73°F and includes 2:1 safety factor.
4. Maximum Pull Force based on actual testing and includes 2:1 safety factor.
5. Internal diameter calculated using nominal outside diameter and minimum wall thickness.
6. Pipe spigot has thickened wall to provide additional joint strength. Ask us for assistance with mandrel sizing if needed.

JOINT PERFORMANCE DATA				
Nom. Size	DR	Pressure Class (psi)	Min. Bend Radius (ft)	Max. Pull Force (lbf)
6"	18	235	144	20,100
	14	305		22,300
8"	18	235	188	27,500
	14	305		31,000
10"	18	235	232	49,500
	14	305		52,600
12"	18	235	275	60,000
	14	305		60,000

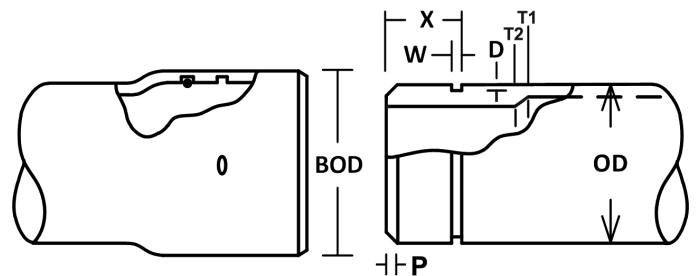



C900/RJIB Certa-Lok® with Fluid-Tite® Gasket PVC Pressure Pipe Restrained Joint Integral Bell

C900/RJIB CERTA-LOK ACCESSORIES									
Application	Nom. Size	Splines				Gaskets			
		Material	Size	Length	Part Number	Material	Shape	Size	Part Number
Standard	6"	Nylon	0.250x0.375	24	S0624TN0	IR/SBR	Profile	N/A	GSPR000600
	8"	Nylon	0.250x0.375	32	S0832TN0	IR/SBR	Profile	N/A	GSPR000800
	10"	Nylon	0.375x0.625	39	S1039TN0	IR/SBR	Profile	N/A	GSPR001000
	12"	Nylon	0.375x0.625	46	S1246TN0	IR/SBR	Profile	N/A	GSPR001200

6" THROUGH 12" C900/RJIB BELL DETAIL:

